

*Sonus faber*

ARTISAN OF SOUND

OMNIA

WIRELESS SPEAKER

DIGITAL BROCHURE



*Sonus faber*

ARTISAN OF SOUND

There is an unspoken understanding between humanity and nature.  
During our lives, we often experience moments where our connection  
with the natural world may waver when faced  
with the vastness and intensity of our surroundings.  
Nature expresses herself through shapes, light, sounds.  
Nature is the home we must enhance.  
Humanity finds connection in music, sharing what we've discovered  
during our time spent in the world of Natural Sound.

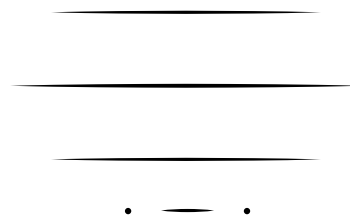

ENHANCE YOUR HOME



CONNECT YOUR MUSIC



DISCOVER NATURAL SOUND

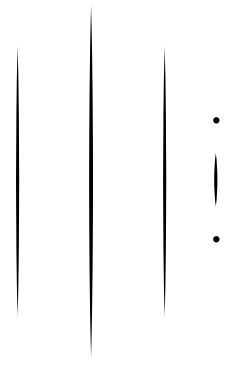



**Omnia** is an ecosystem that embodies Sonus faber's values and heritage, from Italian tradition to modern technologies. An organic architecture of technological desires, exemplified in one, wireless system. Our journey is inspired from connection, the truest relationship of humankind - the link to life. With Omnia, Sonus faber adds to its collection a contemporary and powerful all-in-one active system. The system embraces innovative acoustic technologies with wood elements customary of Sonus faber, fitting seamlessly within any home environment. In today's fast-moving world, Sonus faber's Natural Sound enhances life at home with loved ones.

F E E L T H E V I B E S



## SENSO™

**SENSO™** is Omnia's tactile illuminated wooden top panel. This touch sensitive interface allows direct control of the system, with an additional remote operation available via the supplied handheld controller and user's smartphone or tablet. The illuminated lines indicate Omnia's mode, which streaming service is in use and which input is selected, also allowing the user to adjust the volume.

F E E L   T H E   V I B E S



SENSO™





3" paper pulp cone  
midrange

6.5" long-throw  
aluminum cone  
woofer

.75" silk dome  
tweeters  
with Neodymium  
motor systems

1.75" inverted  
dome in cellulose  
pulp membrane  
wide range

## Acoustic package

The Omnia acoustic package features a 4-way closed box system with 7 drivers driven by a **490 watt** amplifier.

On the front, two **.75" silk dome tweeters** with Neodymium motor systems and two **3" paper pulp cone midrange** drivers guarantee the Sonus faber sound signature and deliver life-like micro-dynamics.

Low frequency is achieved through a **6.5" long-throw aluminum cone woofer** in a down-firing configuration, creating an immersive and impactful sound field.

On both sides of the system, two **1.75" wide range inverted dome cellulose pulp membrane** drivers with **Neodymium motor system**, enhance the sound field with a greater sense of dimensionality in conjunction with newly trademarked technology Omnia is bringing to life: **CRESCENDO™**.

This new technology combines a mix of in-phase bipole and anti-phase dipole sound schemes to redefine the **3D listening experience**. Listeners will discover an endless new world in this 27" package.

The Natural Sound

ENCHANT YOUR SOUL



## CRESCENDO™

Omnia delivers stunning performance: 490 Watts of power driving 7 speakers optimized by Sonus faber, featuring a specially designed new acoustic technology called **CRESCENDO™**. This advanced signal processing system results in a greater sense of dimensionality and immersivity, cleverly utilizing the two full range sides speakers. It creates a crisp wavefront which, through room reflections, mimics that of a live performance. A natural experience just within your room. Omnia can be optimized to perform in any environment, thanks to the Room Placement options and EQ modes selectable on the web-based set up page.

ENCHANT YOUR SOUL



CRESCENDO™



## Connections

Omnia's wide connection options guarantee seamless playback from mobile devices thanks to **Bluetooth**, **Apple AirPlay 2** and **Chromecast** built-in. Of course, WiFi Certified system ensures interoperability and security to users' connections.



Full Wireless Connectivity



TAKE YOUR TIME  
TURN IT ON  
LET GO



Full Wireless Connectivity



## Applications

The intuitive interface allows the users to stream directly with their favorite music service/app(s) thanks to the implementation of **Spotify Connect**, **Tidal Connect** and **Roon Ready**. Music at its best broadcasting nature, handy and wireless.



Full Wireless Connectivity



OPEN YOUR APP  
PLAY YOUR MUSIC  
DANCE LIKE A FOOL



Full Wireless Connectivity



**TURNTABLE READY**  
PHONO STAGE BUILT IN

Omnia also offers analog and digital inputs to provide a complete experience of the iconic natural sound of Sonus faber. Enjoy any analog source through Omnia, thanks to the **MiniDin switchable Phono/Line input** (the MiniDin to RCA cable is supplied).

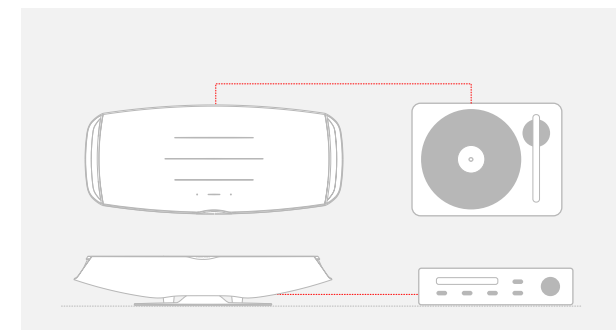

Wired Connectivity



SELECT YOUR VINYL  
PLACE THE NEEDLE  
CLOSE YOUR EYES





**HDMI**<sup>®</sup>  
HIGH-DEFINITION MULTIMEDIA INTERFACE

Omnia features an **HDMI ARC** (Audio Return Channel) input making it easy to enhance all of your television sound with one direct connection.

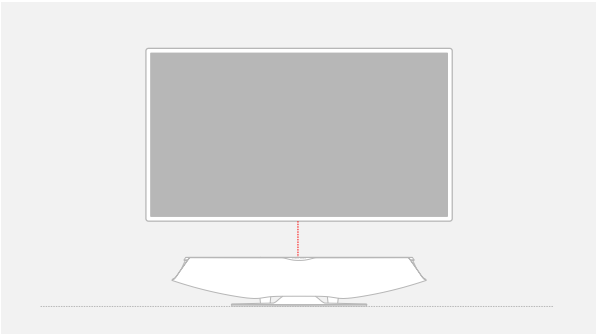

Wired Connectivity

CHOOSE THE MOVIE  
EMBRACE YOUR SOFA  
ENJOY THE EXPERIENCE





OMNIA  
FINISHES  
AND SHAPES

The wood element immediately invokes the iconic Italian design of Sonus faber.

The **Walnut finish** has a traditional and warm appeal. The **Graphite finish** lends Omnia a refined industrial look.



PLAY YOUR MUSIC



DISCOVER NATURAL SOUND

*Sonus faber*  
ARTISAN OF SOUND



*Sonus faber*  
ARTISAN OF SOUND

E N H A N C E   Y O U R   H O M E



D A N C E   L I K E   A   F O O L





F E E L   T H E   V I B E S



*Sonus faber*  
ARTISAN OF SOUND

C O N N E C T   Y O U R   M U S I C





[sonusfaber.com](https://sonusfaber.com)